

文件  
分发  
生管  
业务  
品保  
QA  
IQC  
生技  
注塑  
加工  
冲压  
资料  
工程  
仓库  
IPQC

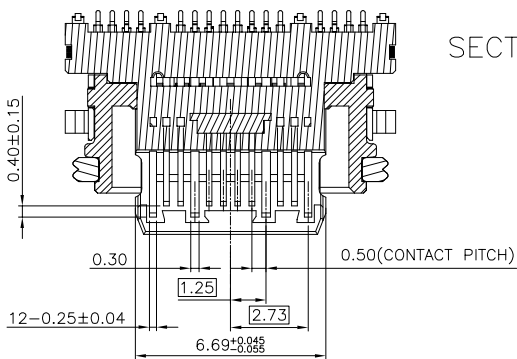

**RoHS Compliant HSF**  
2013/95/EC

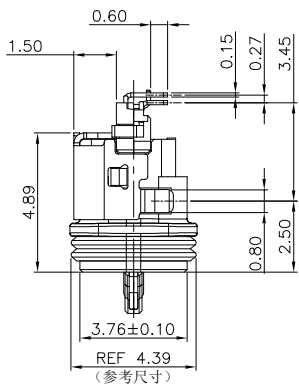
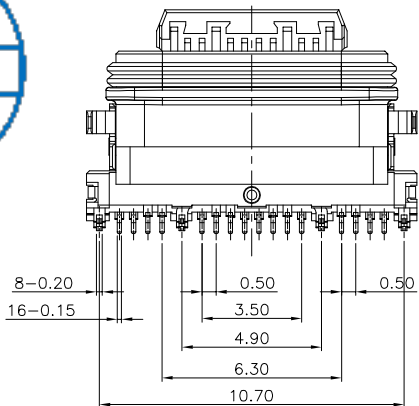
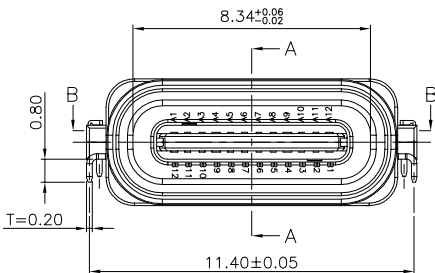
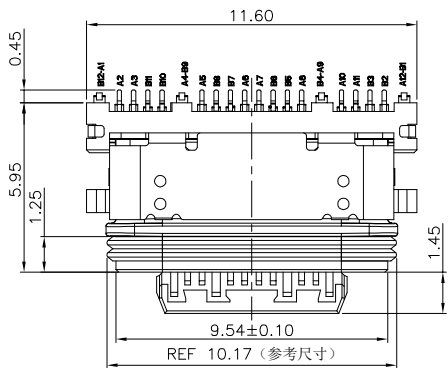

SECTION B-B

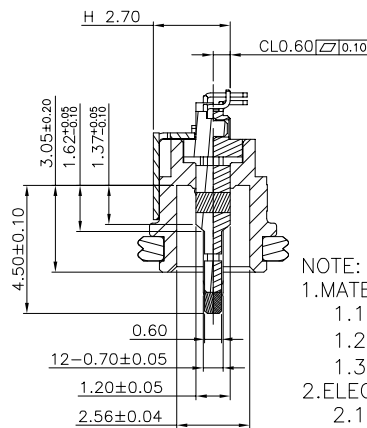

SECTION A-A

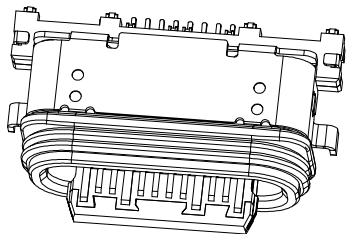

Pin	Signal Name	Mating Sequence	Pin	Signal Name	Mating Sequence
A1	GND	First	B12	GND	First
A2	SSTXp1	Second	B11	SSRXp1	Second
A3	SSTXn1	Second	B10	SSRXn1	Second
A4	Vbus	First	B9	Vbus	First
A5	CC1	Second	B8	SBU2	Second
A6	Dp1	Second	B7	Dn2	Second
A7	Dn1	Second	B6	Dp2	Second
A8	SBU1	Second	B5	CC2	Second
A9	Vbus	First	B4	Vbus	First
A10	SSRXn2	Second	B3	SSTXn2	Second
A11	SSRXp2	Second	B2	SSTXp2	Second
A12	GND	First	B1	GND	First
SHELL	GND		SHELL	GND	

NOTE:

1.MATERIAL:

- 1.1 INSULATOR: HIGH TEMPERATURE PLASTIC UL 94 V-0;
- 1.2 CONTACT: COPPER ALLOY(T=0.15mm)
- 1.3 SHELL:STAINLESS STEEL(T=0.20mm)

2.ELECTRICAL CHARACTERISTICS;

- 2.1 CONTACT RESISTANCE: 40mΩ Max FOR INITIAL. 10mΩ CHANGE AFTER TEST. MEASURE AT 20mV, 100mA.
- 2.2 CONTACT CURRENT RATING: 5A FOR COLLECTIVELY POWER SUPPLY PIN(PINA1,A4,A9,A12,B1,B4,B9,B12); 1.25A FOR VCONN PIN; 0.25A FOR OTHER SIGNAL PIN.
- 2.3 DIELECTRIC WITHSTANDING VOLTAGE: 100V AC R.M.S.
- 2.4 INSULATION RESISTANCE 100MΩ Min
- 2.5 OPERATING TEMPERATURE: -40°C ~ 85°C

3. MECHANICAL CHARACTERISTICS:

- 3.1 INSERTION FORCE: 5~20 N.
- 3.2 EXTRACTION FORCE: 8~20N
- 3.3 DURABILITY: 10,000
- 3.4 THE EXTRACTION FORCE SHALL BE WITHIN THE RANGE OF 6N~20N AFTER 10000.

4.PLATING

- 4.1 TERMINAL CONTACT: (SEE TAB) GOLD PLATING ALL OVER 50u" Min NICKEL AND 80u"Min Tin ALL OVER 50u" Min NICKEL ON SOLDER AREA
- 4.2 OUT SHELL: 50u" Min. NICKEL ALL OVER
- 4.3 INNER SHELL: 50u" Min. NICKEL ALL OVER

5.PART NUMBER:

1187-21X07-23A

1: G/F 2: 5u" 3: 10u"  
4: 15u" 5: 30u"

TOLERANCES UNLESS OTHERWISE SPECIFIED

UNIT	(MM)
X.	±0.50
X.X	±0.30
X.XX	±0.20
X.XXX	±0.10
ANGEL	±2'

**PowerCenter** 力源科技 (香港) 有限公司  
**力源科技力郡电子** 力郡电子科技有限公司  
POWERCENTER TECHNOLOGY LIMITED

ORIGINAL DATA	TITLE	SCALE	SIZE
2022.09.05	USB4.0 CF WATERPROOF CL0.60 SMT TYPE FOR IPX8 WOL	1:1	A4
DWN. Rain			
CHK.	PART NO. 1187-21X07-23A		
APVD. FCC	DWG NO. 1187-21107-23A	SHEET 1/3	REV. B

REV.	DESCRIPTION	ECN NO.	DWN.	CHK.	APVD.	DATE
B	更正包装数量	20230704058	YWL	FCC	FCC	2023.07.04
A	NEW DARWING	ECN NO.	Rain	Chain	DC	2022.09.05



文管中心  
2023.07.07  
发行

文件分发  
生管  
业务  
品保  
QA  
IQC  
生技  
注塑  
加工  
冲压  
资料  
工程  
仓库  
IPQC



**RoHS Compliant HSF**  
2013/95/EC

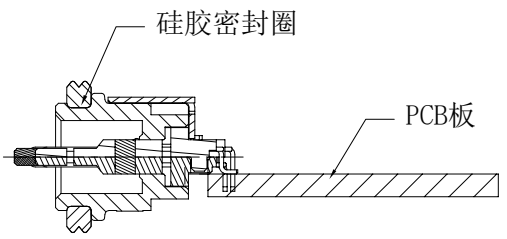
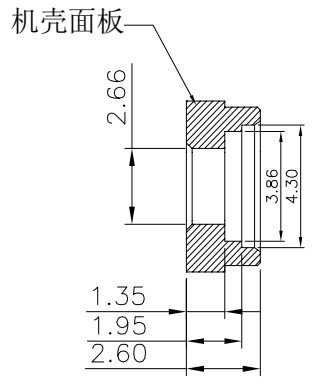

组装方式，左右方向装配

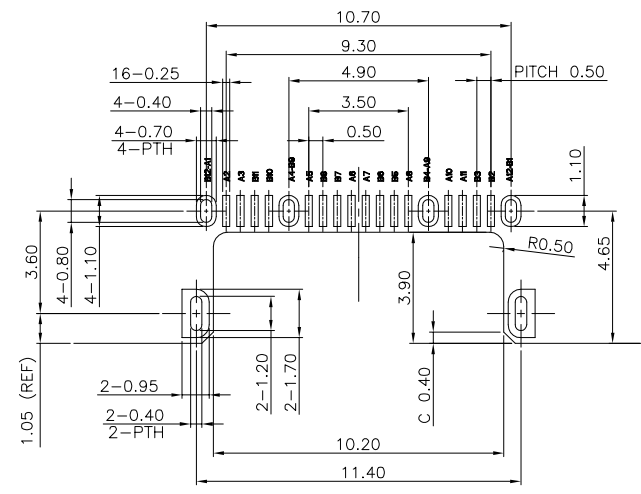

RECOMMEND P.C.B LAYOUT (COMPONENT SIDE)  
TOLERANCE FOR PCB LAYOUT IS ± 0.05

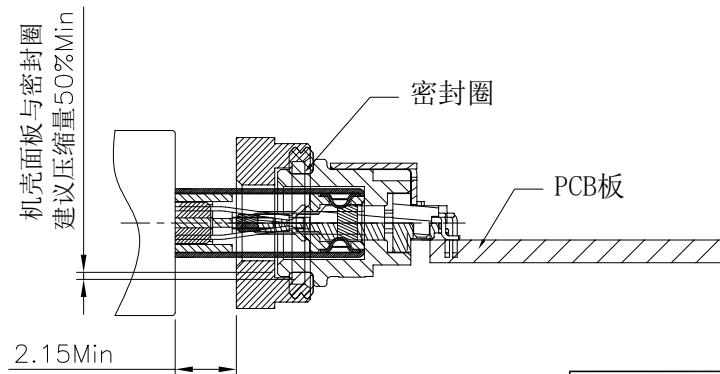
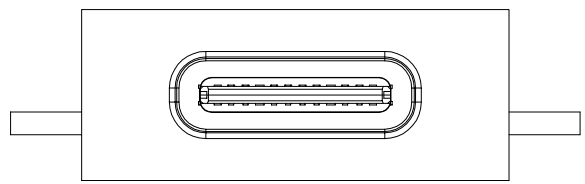

组装面板后公母头对插示意图



B	更正包装数量	20230704058	YWL	FCC	FCC	2023.07.04
A	NEW DARWING	ECN NO.	Leiny	Chain	DC	2022.09.05
REV.	DESCRIPTION	ECN NO.	DWN.	CHK.	APVD.	DATE

TOLERANCES UNLESS OTHERWISE SPECIFIED

UNIT	(MM)
X.	±0.50
X.X	±0.30
X.XX	±0.20
X.XXX	±0.10
ANGEL	±2'
3RD.ANGLE'S	

<b>PowerCenter</b> 力源科技(香港)有限公司 力源科技力郡电子 力郡电子科技有限公司 POWERCENTER TECHNOLOGY LIMITED			
ORIGINAL DATA 2022.09.05	TITLE USB4.0 CF WATERPROOF CLO.60 SMT TYPE FOR IPX8 WOL		
DWN. Rain	CHK.		
APVD. FCC	PART NO. 1187-21X07-23A	SCALE 1:1	SIZE A4
	DWG NO. 1187-21107-23A	SHEET 2/3	REV. B

文件  
分发  
生管  
业务  
品保  
QA  
IQC  
生技  
注塑

**Pb** **RoHS Compliant** **HSF**  
Process Capable 2013/95/EC

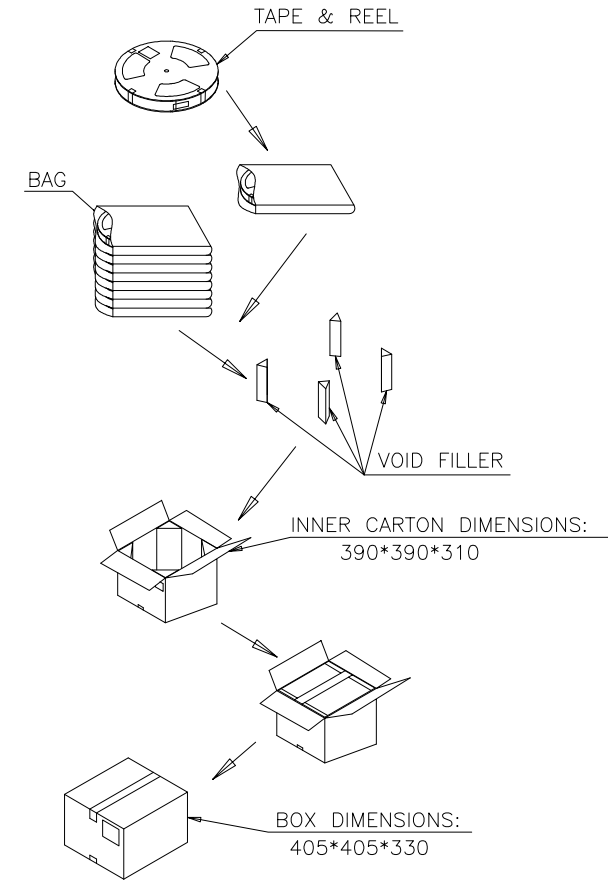
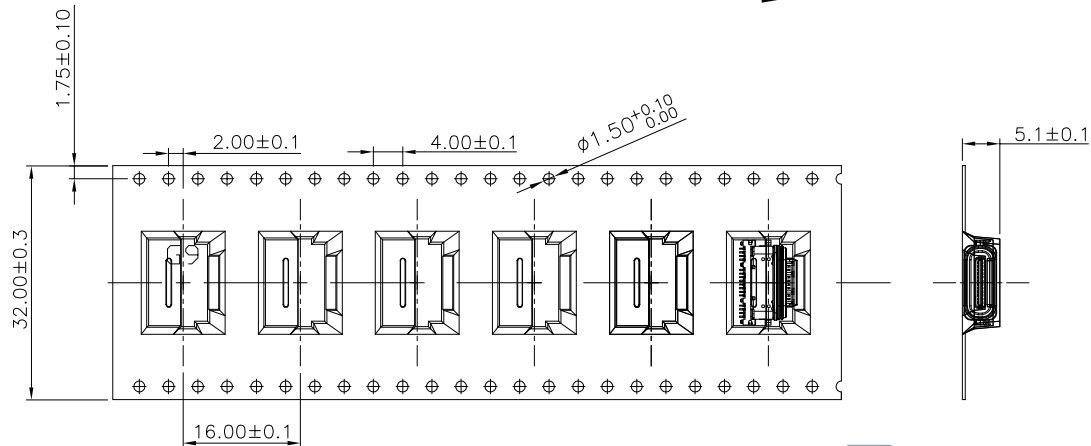
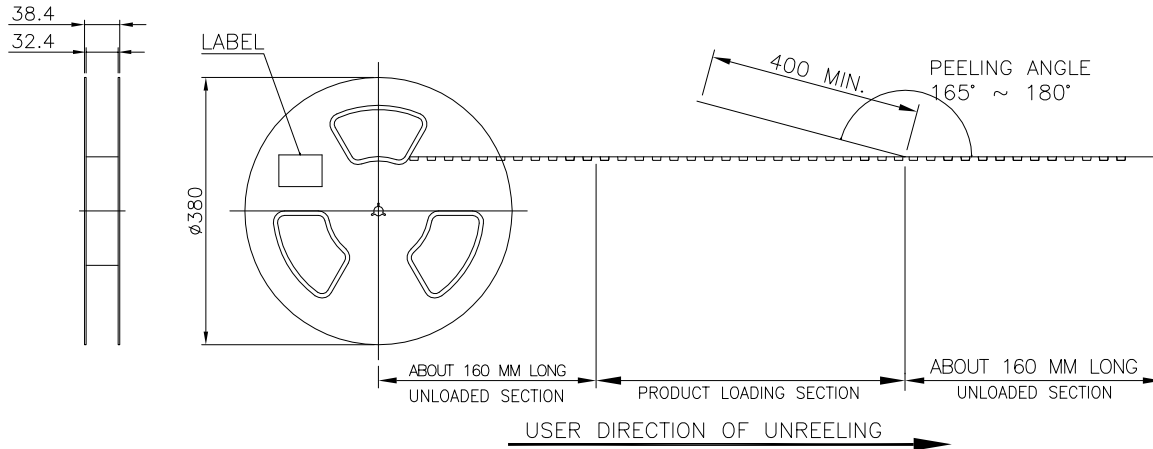

NOTE:

- MATERIAL:  
BOX: FIBREBOARD, CORRUGATED, DOUBLE WALL.  
TAPE: POLYSTYRENES, HEAT-RESISTANT TEMPERATURE: 120°C, BLACK COLOR.  
REEL: POLYSTYRENES, HEAT-RESISTANT TEMPERATURE: 70°C, BLUE COLOR.  
BAG: POLYETHYLENE, HEAT-RESISTANT TEMPERATURE: 100°C.
- PEELING STRENGTH: 0.1 ~ 1.3 N (10 ~ 130 GRAMS)
- PEELING SPEED: 300 mm/min.
- EACH BAG SHALL BE INCLUDED DESICCANT.



B	1000	8	8000 PCS	-- KG	-- KG
	PCS/ REEL	REELS/ CARTON	QUANTITY	GROSS WEIGHT	NET WEIGHT

TOLERANCES UNLESS OTHERWISE SPECIFIED		<b>PowerCenter</b> 力源科技 (香港) 有限公司 力源科技力郡电子 力郡电子科技有限公司 POWERCENTER TECHNOLOGY LIMITED			
UNIT (MM)		ORIGINAL DATA	TITLE		
X. ±0.20		2022.09.05	USB4.0 CF WATERPROOF		
X.X ±0.15		DWN. Rain	CLO.60 SMT TYPE FOR IPX8 WOL		
X.XX ±0.10		CHK.	PART NO.	SCALE	SIZE
X.XXX ±0.05			1187-21X07-23A	1:1	A3
ANGEL ±1'		APVD. FCC	DWG NO.	SHEET	REV.
			1187-21107-23A	3/3	B

B	更正包装数量	20230704058	YWL	FCC	FCC	2023.07.04
A	NEW DARWING	ECN NO.	Rain	Chain	DC	2022.09.05
REV.	DESCRIPTION	ECN NO.	DWN.	CHK.	APVD.	DATE